



Document 23-525

Book 2023 Page 525 Type CORNR Pages 1
Date 2/10/2023 Time 10:03 AM
Rec Amt \$7.00

NAOMI ELLIS, RECORDER
MARION COUNTY IOWA

Prepared By: J. Brian Morrissey, Morrissey Surveying & Consulting, LLC, 140th Hwy. G28, Otley, Ia. 50214, 515-480-2531

UNITED STATES PUBLIC LAND SURVEY CORNER CERTIFICATE OF

Land Survey Monuments situated in Section 24, Township 74N, Range 20W, of the Fifth Principal Meridian, Marion County, Iowa.
Previously recorded in Bk. 1, P. 191 in the County Recorder's Office.
(book, page, document number, etc.)

(Show reason for preparing this certificate, the evidence and detailed procedures used in establishing the corner positions and monumentation found or placed.)

Monument Description and Remarks: Found 5/8" rebar in the centerline of Upton St., accepted position.
Previous ties altered or obliterated.

This Corner was used for a Plat of Survey in the NW 1/4 of the SE 1/4, Sec. 24, T-74N, R-20W

PLAN VIEW

(Show a minimum of three reference ties to durable physical objects, relevant monuments and physical conditions that will enable recovery of the corner.)

IOWA STATE PLANE
COORDINATES
NAD83, SOUTH ZONE

NORTHING: 436403.86
EASTING: 1750679.60

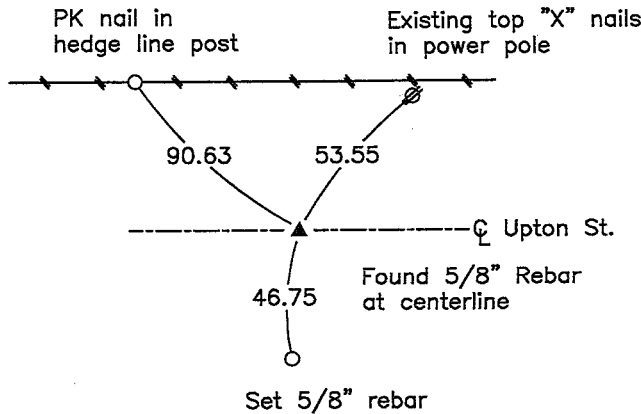
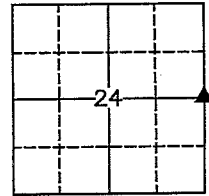

NE Cor., of the SE 1/4, Section 24

Date of Survey: 9/30/22

NOTE: ALL TIES TO BRASS DISK OR YELLOW/ORANGE SURVEY MARKER UNLESS NOTED.

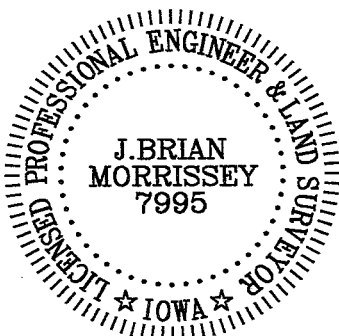

I hereby certify that this land surveying document was prepared and the related survey work was performed by me or under my direct personal supervision and that I am a duly Licensed Land Surveyor under the laws of the state of Iowa.

Signature: J. Brian Morrissey Date: 2/9/23
J. Brian Morrissey

License number 7995.

My license renewal date is December 31, 2023

1147-21-1/1

pd # 700 check - Ret J. Brian Morrissey