

KAREN SCHWANEBECK, RECORDER
MARION COUNTY IOWA

Prepared by: Abie C. Davis, P.E. & L.S., 1428 Oregon St., Knoxville, Iowa 50138 Phone: (515) 842-5863

UNITED STATES PUBLIC LAND SURVEY CORNER CERTIFICATE

SLS19-94

OF

Land survey Monuments situated in Section 31, Township 74N, Range 20W, of the Fifth Principal Meridian, Marion County, Iowa.

Previously recorded in N/A in County Recorders Office.

Show reason for preparing this certificate, the evidence and detailed procedures used in establishing the corner positions and monumentation found or placed

Monument Description and Remarks: Found Iron Pin over CM

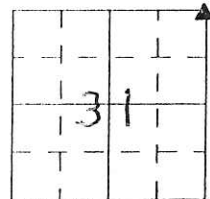

PLAN - VIEW

(Show a minimum of three reference ties to durable physical objects, relevant monuments and physical conditions that will enable recovery of the corner.)

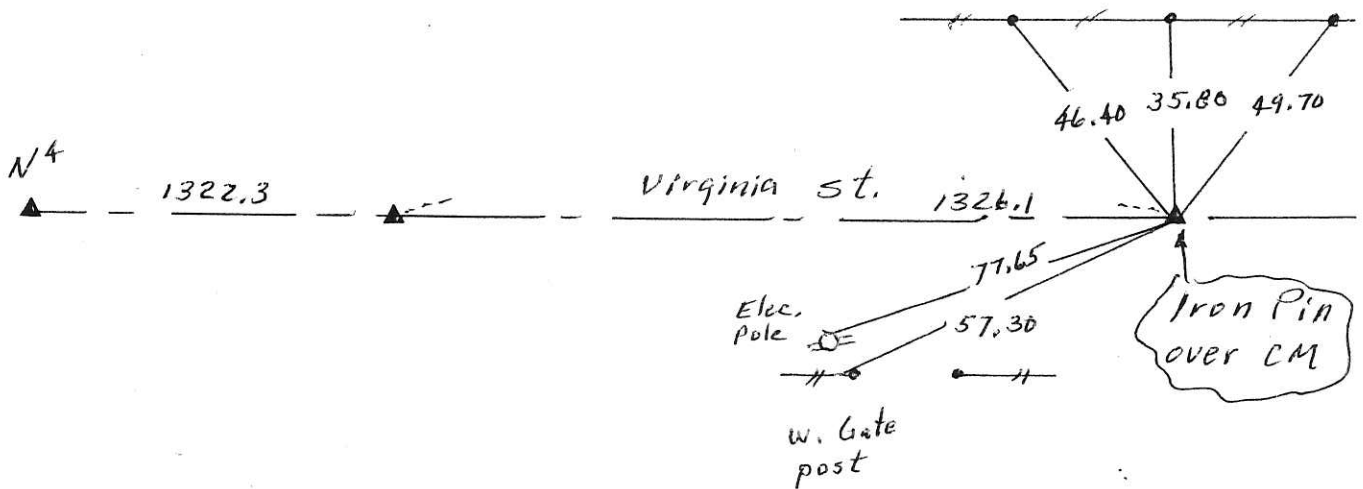

I hereby certify that the survey work was completed and this land surveying document was prepared by me or under my direct personal supervision and that I am a duly licensed land surveyor under the laws of the state of Iowa

Signature: Abie C. Davis
Abie C. Davis, P.E. & L.S.

Date: 9/15/16 Reg. No. 5594

My license renewal date is December 31, 2017

SEAL

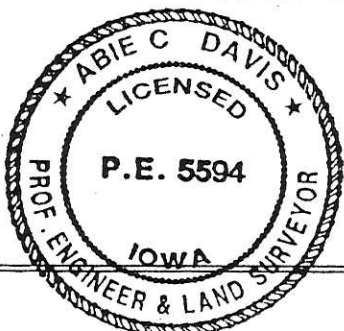

List Corners to be Indexed			
Corners	Section	Twp	Range
NE	31	74N	20W

Pd \$700 Cash - Ret Abie Davis

Found pieces of 2" o tile 4" long
and fragments .4" piece tall
apart while removing from hole.

Plumbed and set CM placing
pieces of tile at base of CM
Selected Flint Rock 11" x 6" x 7"
and placed on top CM. 6" deep
Top CM. 17" deep.

N.E. Cor. 31-74-20.

Sat. 6-11-40 (sprinkling rain)

Kennedy, Ogden, Shurtz, Mitchell Notes: Mignall

