



GARDEN & ASSOC.

P.O. Box 451, Oskaloosa, Iowa 52577-0451 Phone: (641)672-2526

KAREN SCHWANEBECK, RECORDER
MARION COUNTY IOWA

UNITED STATES PUBLIC LAND SURVEY CORNER CERTIFICATE

OF

Land Survey Monuments situated in Section 28, Township 74, Range 20, of the Fifth Principal Meridian, MARION County, Iowa. Previously recorded in NO CERTIFICATE OF RECORD in County Recorder's Office. Monument Description and Remarks: SEE BELOW

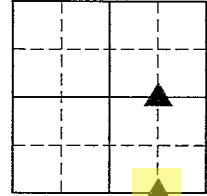

NW COR NE-SE

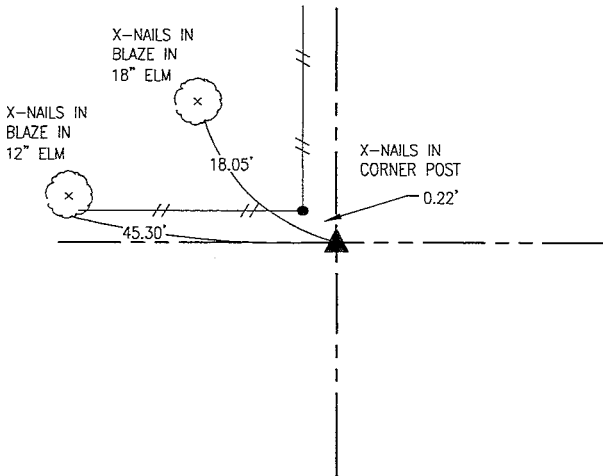

MARCH 2021
SEARCHED AREA AROUND CORNER POST BUT DID NOT FIND ANY MONUMENTATION. SET 5/8" X 30" REBAR WITH YELLOW PLASTIC CAP #19960 AT CORNER POST. THIS POSITION LINES UP WELL WITH EXISTING FENCE TO THE WEST. THE DISTANCE TO THE EAST 1/4 MATCHES FENCE SPLITS FARTHER WEST AS WELL.

SW COR SE-SE

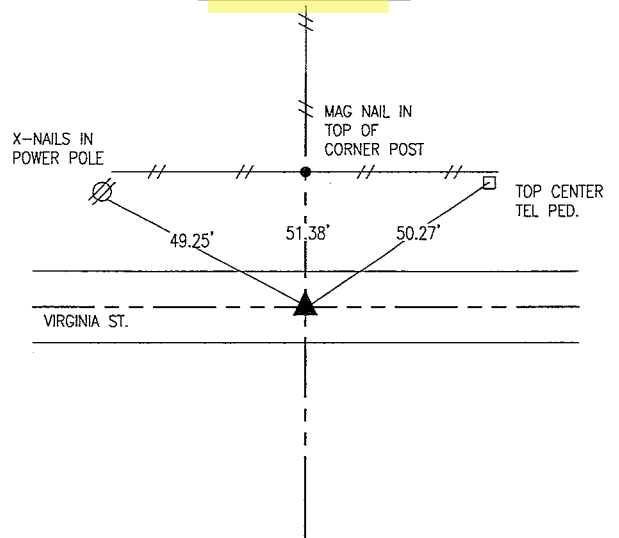

MARCH 2021
SEARCHED AREA AROUND CORNER POST BUT DID NOT FIND ANY MONUMENTATION. SET 5/8" X 30" REBAR WITH YELLOW PLASTIC CAP #19960 ON LINE BETWEEN THE SE CORNER AND SOUTH 1/4 IN LINE WITH FENCE TO THE NORTH. THE DISTANCE EAST TO THE SE CORNER OF SECTION MATCHES THE ROAD PLAN DIMENSION WITHIN 1.5 FEET.

I hereby certify that this land surveying document was prepared and the related survey work was performed by me or under my direct personal supervision and that I am a duly licensed Professional Land Surveyor under the laws of the State of Iowa.

Bobby J. Maddaleno 3-22-21
Bobby J. Maddaleno, P.L.S. Date

License number: 19960
My license renewal date is December 31, 2021

SEAL

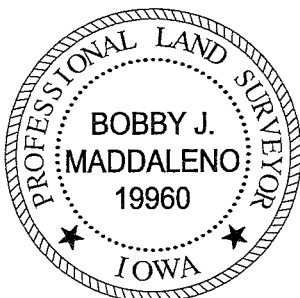

List Corners to be Indexed			
Corners	Section	Township	Range
NW COR NE-SE	28	74	20
SW COR SE-SE	28	74	20

RJ #700 Ck - Ret Garden & Assoc. Env.