

Found 1-2" round tile
(Watkins Tile)

Set CM over the 8' round
tile laid in place. We put
a sand stone 10" x 6" x 2"
on top CM.

K 1/4 Cor 3-74-80
Set Aug-12-1941
Party: Wells, Glass, Ford

Notes: Kennedy

Con. Man. 15' deep
10" x 6" x 2" Sandstone
on top. Set 15' of
Broken steel post on
S. side 5" deep.

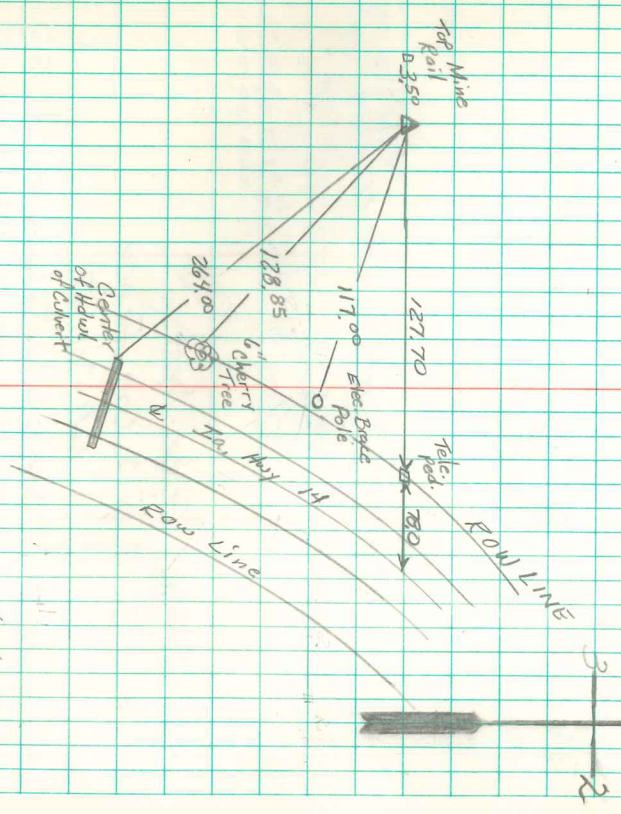

Ret'd
1/6/93 Abie Davis