

Found 1-3" round Tile 1-4" Tile  
 with 1-D tile in ctr. & one tile  
 under c.m.

Set C.M. over 1-4" Tile.

N<sup>1</sup>/<sub>4</sub> Cor 20-75-19  
 Set 7-9-40  
 Notes - W. S. G. M. N

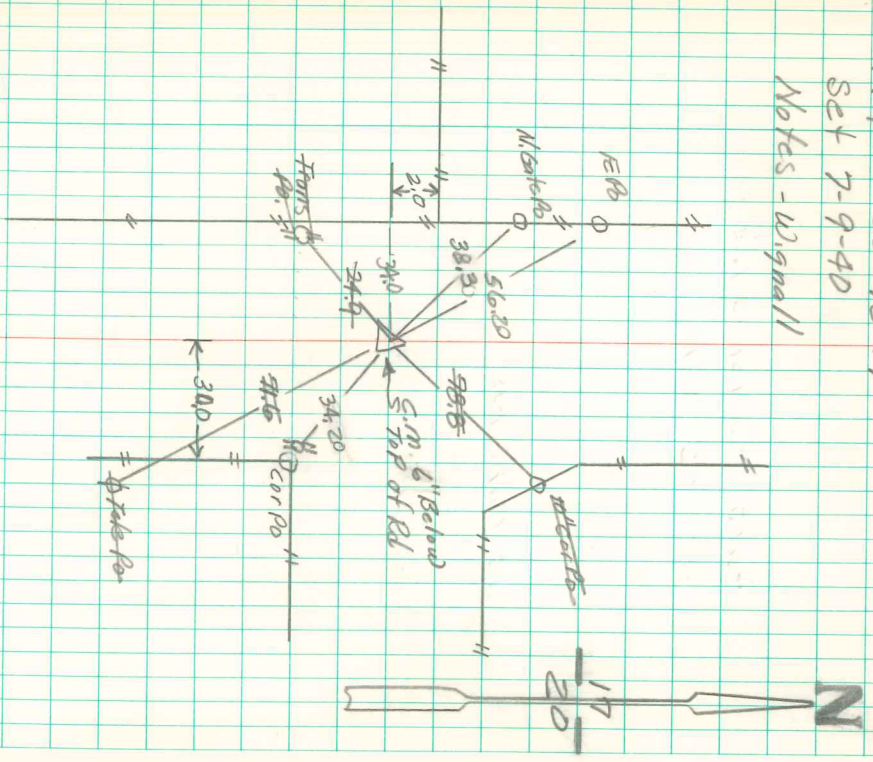

Retied 9/3/90 MCL  
 Set Iron Pipe on N. side CM  
 Top CM Broken off