

INDEX LEGEND

COUNTY: MARION
SECTION: 36, T-75N, R-19W
CORNER: NE Corner of the NW 1/4 of the SW 1/4

SURVEYOR & SURVEY COMPANY:
Jason S. Lowry, P.L.S.
Lowry Land Services, L.L.C.
752 Diamond Trail Rd., Searsboro, Iowa 50242

PREPARED BY AND RETURN TO:
Jason S. Lowry, P.L.S.
752 Diamond Trail Rd., Searsboro, Iowa 50242
(641) 521-1160, lowrylandservices@gmail.com

Instr. Number: 23-3445
BK: 2023 PG: 3445
Recorded: 8/21/2023 at 9:41:41.0 AM
County Recording Fee: \$7.00
Iowa E-Filing Fee: \$3.00
Combined Fee: \$10.00
Revenue Tax:
NAOMI ELLIS, RECORDER
Marion County, Iowa

UNITED STATES PUBLIC LAND SURVEY CORNER CERTIFICATE

Land Survey Monument situated in Section 36, Township 75 North, Range 19 West of the Fifth Principal Meridian, Marion County, Iowa. Not previously recorded.

MONUMENT DESCRIPTION & REMARKS

NE Cor. NW 1/4 SW 1/4— No record of corner being set. Searched area and found nothing. Set 5/8" x 18" pink plastic capped rebar, P.L.S. #22291, at midpoint and on line between W 1/4 Corner and calculated Center of Section. No certificate of record.

This corner was used for a plat of survey in the W 1/2 of Section 36.



PLAN VIEW

No Scale

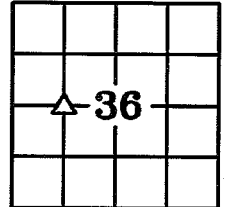

NE Corner
of the NW 1/4
of the SW 1/4
Section 36

Set 5/8" x 18" pink plastic capped rebar, P.L.S. #22291

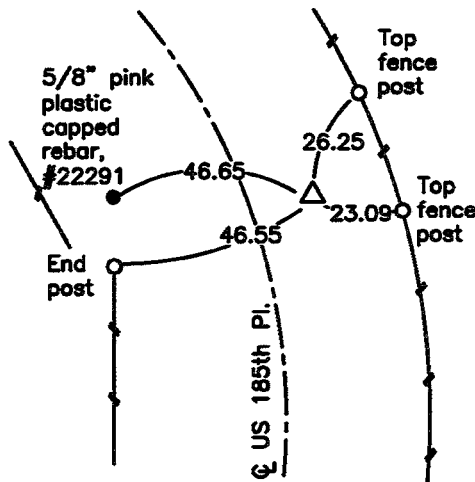

NOTE: ALL TIES ARE PLUMB MEASUREMENTS TO ORANGE SURVEY MARKER UNLESS NOTED.



I hereby certify that this land surveying document was prepared and the related survey work was performed by me or under my direct personal supervision and that I am a duly Licensed Land Surveyor under the laws of the State of Iowa.

My license renewal date is 12/31/2023

Pages covered by this seal: 1 - 1

Jason S. Lowry
Jason S. Lowry

08/09/2023

Iowa Lic. No. 22291

Date

LEGEND

- ▲ Section Corner Found
- △ Section Corner Set
- Existing Fence

LAND CORNER TO BE INDEXED

Land Corner	Section	Township	Range
NE Cor. NW 1/4 SW 1/4	36	75	19

LOWRY LAND SERVICES, L.L.C.

752 DIAMOND TRAIL RD., SEARSBORO, IOWA 50242, 641-521-1160

PROJ. NO. 5923

DATE OF SURVEY: 08/07/23

CERT NO. 2/3