

Found sandstone 16"x10"x4" over
2-2 1/2" round tile

Set C.M. over round Tile.

4/21/83 - Find WPA C.M. 9" Deep at Fence line
intersection. Set 3/4"x24" pipe on E. side of C.M.

E⁴ Cor. 33-77-19

4/11/08 - Find WPA C.M. 9" Deep on W. side
of Corps of engineer boundary
sign post.

"X" Nails in 8"
corner of 6" Base Post

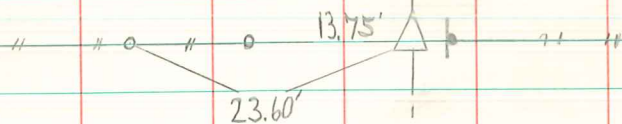

4/25/08
Randal Nigro

E 1/4 Cor 33-77-19
Set - 10-13-39
Notes - Kennedy
Party -

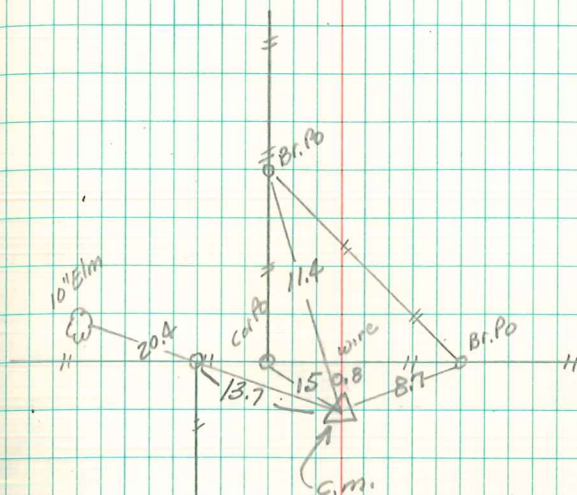

New Tie

33 34